



# LCD Monitor Quick Start Guide

DesignVue Designer Monitor | PD Series



DN: PD05Q-EQ-V2

© 2022 BenQ Corporation. All rights reserved. Rights of modification reserved.

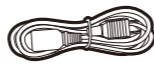
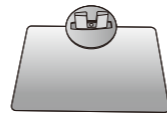
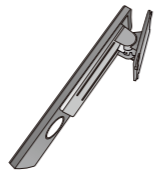
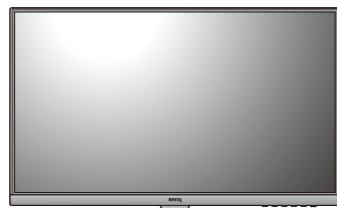
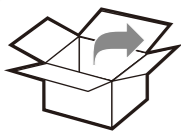

USB



USB-C™



DP



HDMI  
(optional)

The terms HDMI, HDMI High-Definition Multimedia Interface, HDMI Trade Dress and the HDMI Logos are trademarks or registered trademarks of HDMI Licensing Administrator, Inc.

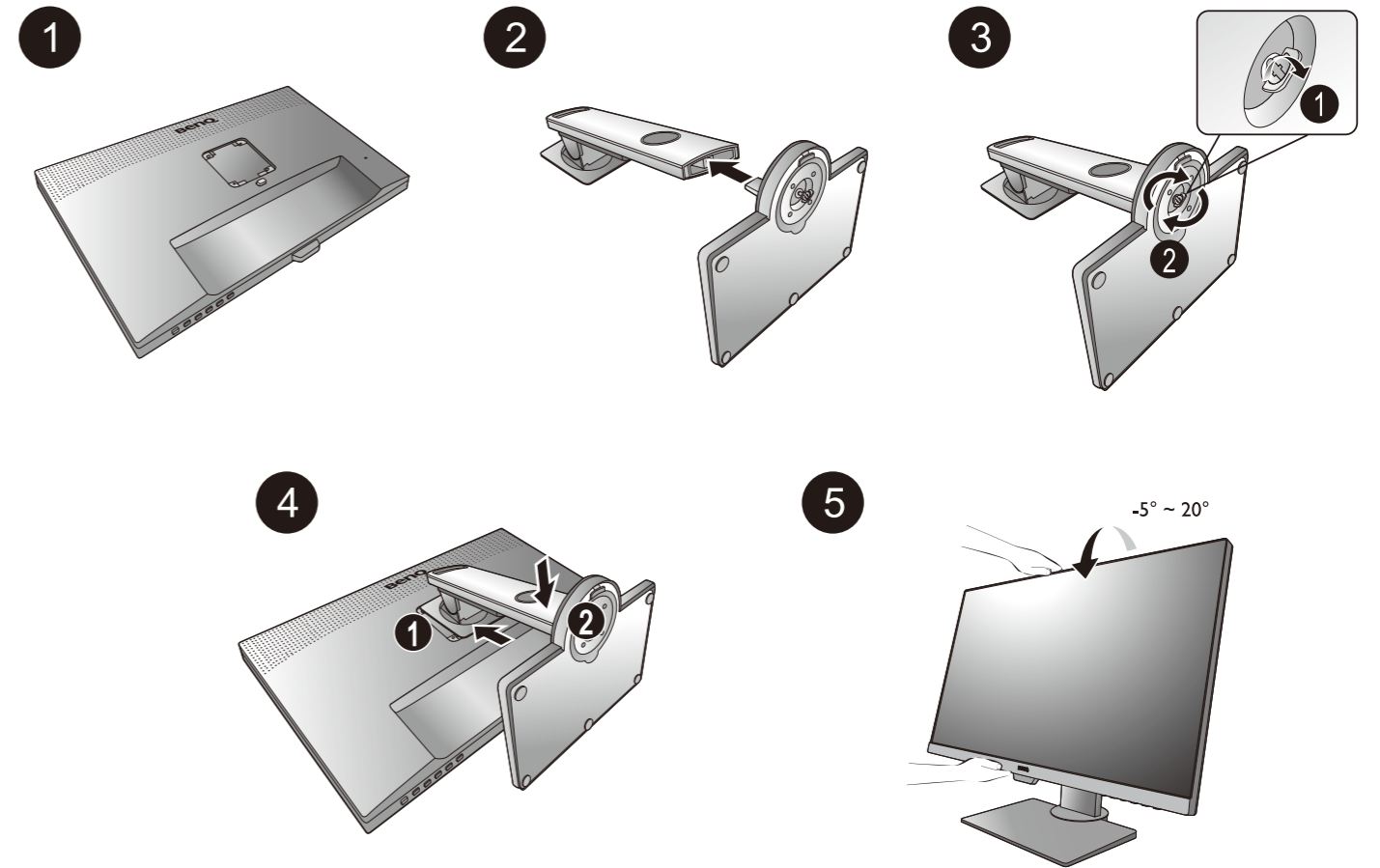
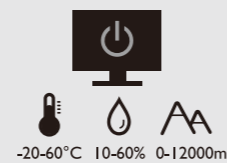
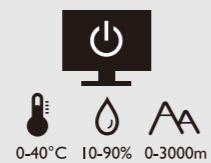

- 6 Video
- 7 Audio
- 8 USB

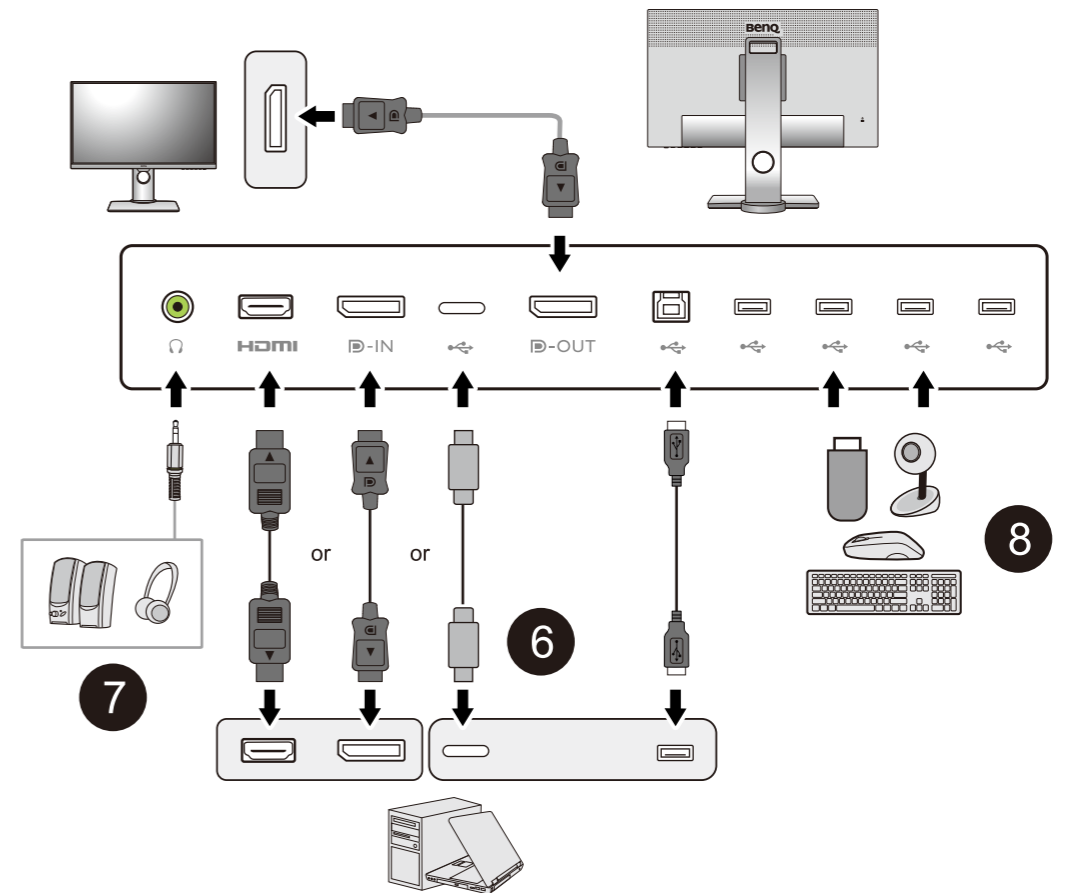

9

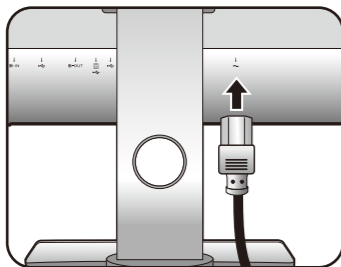

10

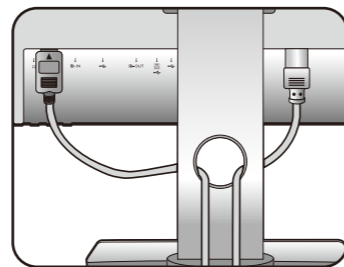

11

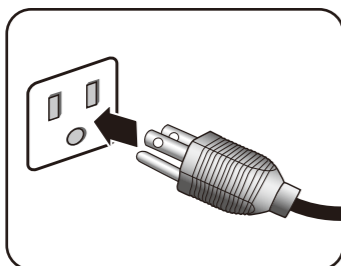

12

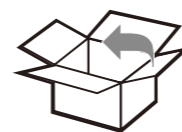
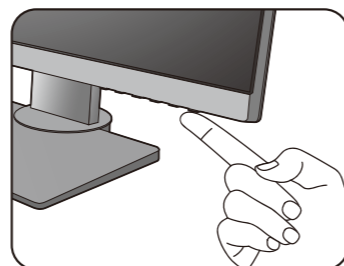

1

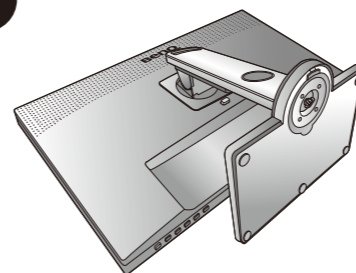

2

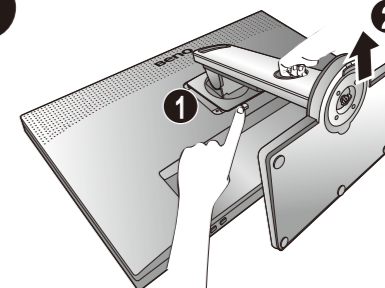

3

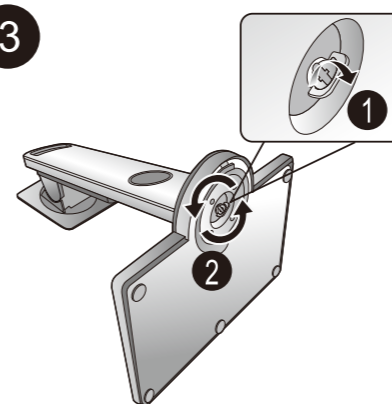

4

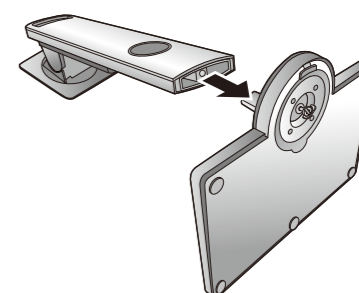

### Software installation

Display Pilot: for display arrangement & color matching (ICC Sync)

Support.BenQ.com

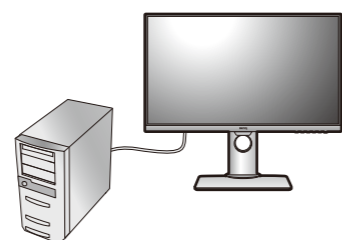

How to use Display Pilot



How to use ICC Sync

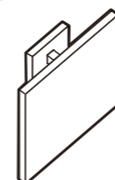

1

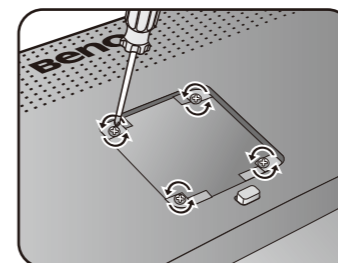

M4 x 10 mm

2

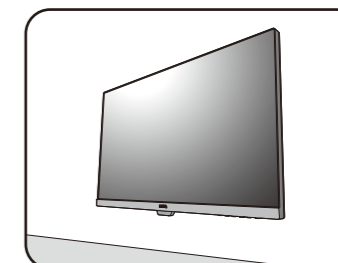

### Connecting multiple monitors via MST (Multi-Stream Transport)

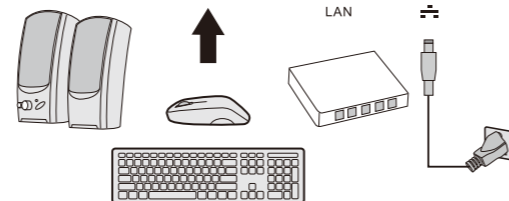
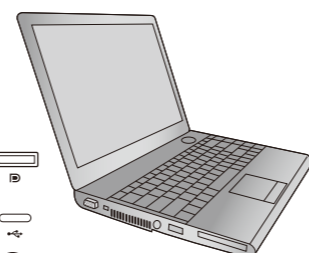
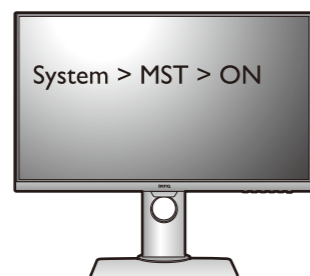
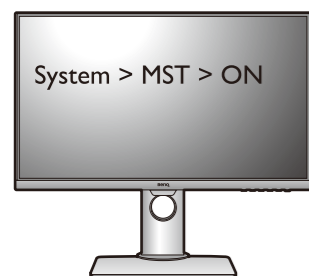

Support.BenQ.com

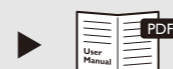

Online Manual



Product Support



Software Download

For professional color display



CAD / CAM Mode



Animation Mode

For work efficiency



DualView



KVM Switch